



**Description**  
 On the north-east side, from a point 18.3 metres southeast of its junction with Worple Road, southeast for a distance of 7.2 metres.

EV sign to go on lamp column 1.

**KEY**

- EV Electrical charging bay
- New post
- Crossovers
- Permit holder bay
- Shared use bay
- Lamp Column

**Note**

Main sign to have an x-height of 20mm

Subplate to have an x-height of 15mm

Remove existing sign and return to Civic Centre

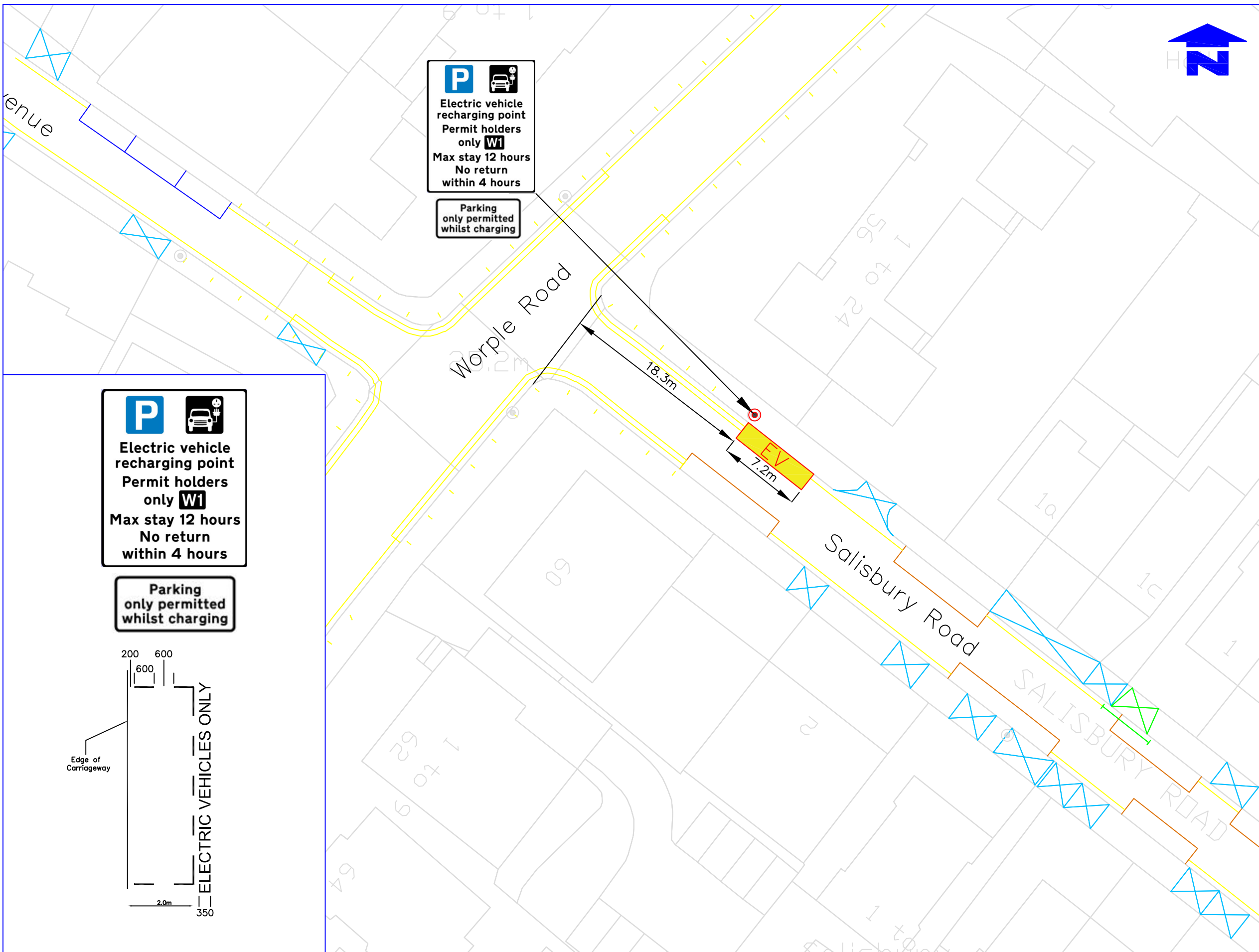

**P**   
 Electric vehicle recharging point  
 Permit holders only **W1**  
 Max stay 12 hours  
 No return within 4 hours

Parking only permitted whilst charging

**P**   
 Electric vehicle recharging point  
 Permit holders only **W1**  
 Max stay 12 hours  
 No return within 4 hours

Parking only permitted whilst charging

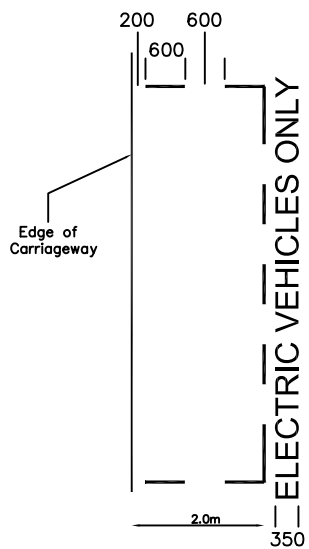

Notes  
 Do not scale from this drawing

Rev.	Revisions	Drawn	Sig.	Date	Chkd.	Sig.	Date	App.	Sig.	Date

ENVIRONMENT  
 CIVIC PRIDE & CLIMATE  
 DEPARTMENT

FUTURE MERTON

PROJECT  
**LAMP COLUMN EV  
 CHARGING BAYS**

TITLE  
 Salisbury Road (near Worple Road)  
 Wimbledon SW19 4EZ (Zone W1)



Drawing No.  
 Z30-011-02

Revision

Classification  
**CONSTRUCTION**

Scale  
 1:500