



**Description**  
 On the southwest side. From a point 10 metres northwest of its junction with Cambridge Road, northwest for a distance of 5.5 metres.

EV sign to go on lamp column 1.

- KEY**
- Electrical charging bay
  - + post
  - X Crossovers
  - Permit holder bay
  - Shared use bay
  - Lamp Column

**Note**

Main sign to have an x-height of 20mm

Subplate to have an x-height of 15mm

Remove and return existing permit holder bay sign

BATCH 13

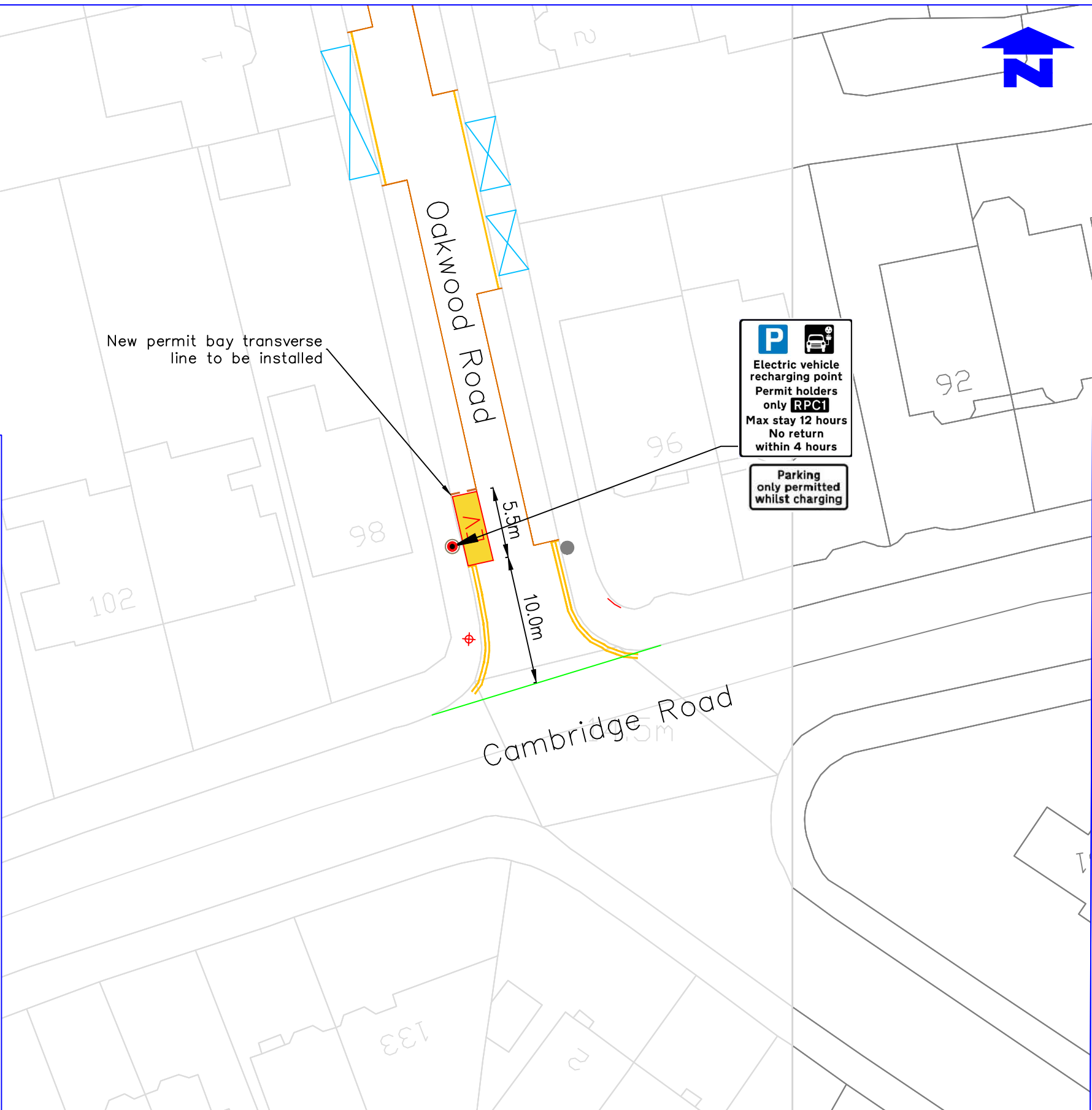

**P** **Electric vehicle recharging point**  
 Permit holders only **RPC1**  
 Max stay 12 hours  
 No return within 4 hours

**Parking only permitted whilst charging**

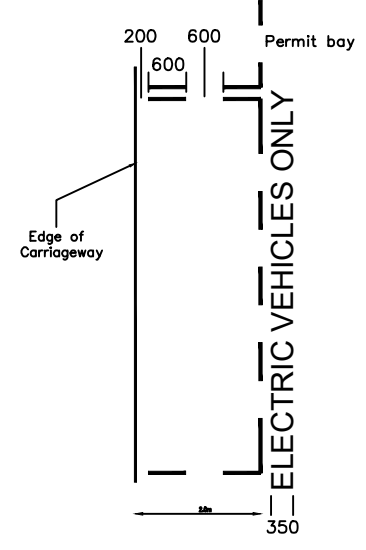

**P** **Electric vehicle recharging point**  
 Permit holders only **RPC1**  
 Max stay 12 hours  
 No return within 4 hours

**Parking only permitted whilst charging**

Notes  
 Do not scale from this drawing

| Rev | Revisions | Drawn | Sig. | Date | Chkd. | Sig. | Date | App. | Sig. | Date |
|-----|-----------|-------|------|------|-------|------|------|------|------|------|
|     |           |       |      |      |       |      |      |      |      |      |

ENVIRONMENT  
 CIVIC PRIDE AND CLIMATE  
 DEPARTMENT

FUTURE MERTON

Reproduced from/based upon the Ordnance Survey's 1:1250 maps with the permission of the Controller of H.M.S.O. Crown Copyright Reserved. Unauthorised reproduction infringes Crown copyright and may lead to prosecution or civil proceedings. London Borough of Merton 100019259 2005

|             |      |        |
|-------------|------|--------|
| Drawn by    | Sig. | Date   |
| SC          |      | Aug 23 |
| Checked by  | Sig. | Date   |
| SC          |      | Aug 23 |
| Approved by | Sig. | Date   |

PROJECT  
**LAMP COLUMN EV CHARGING BAYS**

TITLE  
 Oakwood Road (Near Cambridge Road)  
 Wimbledon, SW20 0PN (Zone RPC1)



Drawing No.  
 Z30-013-08

Revision

Classification  
**CONSTRUCTION**

Scale  
 1:500